

AI SIBOXER-01

AIR-OPERATED DOUBLE DIAPHRAGM PUMPS

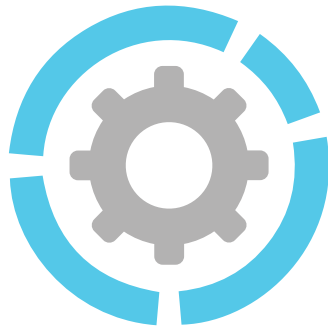

DEBEM
HYGIENIC SOLUTIONS



Suction/delivery connections	BS 4825 1" Clamp
Air fitting	3/8" f BSPP
Max flow rate*	100 l/min
Max air supply pressure	8 bar
Max head*	80 m
Max suction from negative head - dry running*	2,5 m
Max suction from negative head - with pump on	9,5 m
Max diameter of suspended solids	5 mm

* The value depends on the pump configuration.



HpE PROCESS

CE



Product designed and built in Italy

PATENTED anti-stall pneumatic circuit

Operates with NON-lubricated air

SELF-PRIMING

It supports dry running

Possibility of adjusting the operating speed

Versatility of use

Suitable for handling fluids with high viscosity and for heavy applications

Possibility of handling fluids with suspended solids

Suitable for continuous service

AISIBOXER-01

AIR-OPERATED DOUBLE DIAPHRAGM PUMPS



Specifications and types

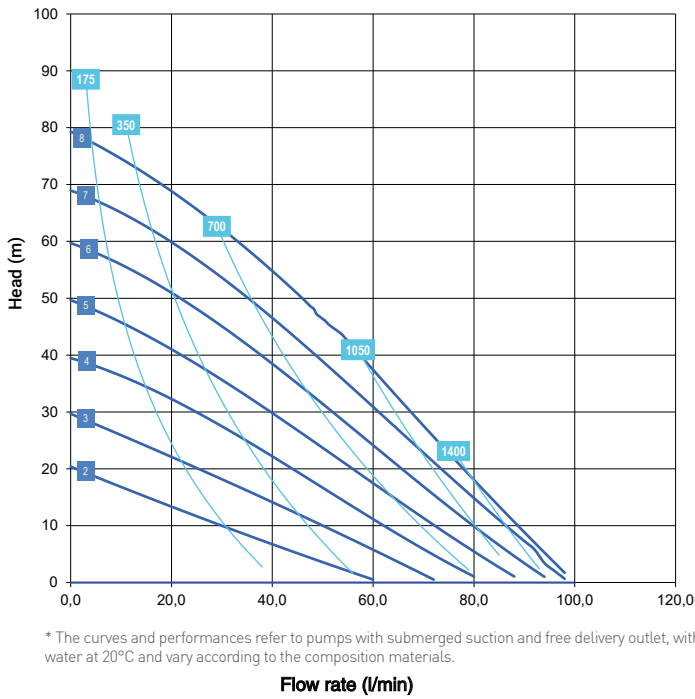

* The curves and performances refer to pumps with submerged suction and free delivery outlet, with water at 20°C and vary according to the composition materials.

■ Air supply pressure (bar) ■ Air consumption (NI/min)



Quick emptying system

A system that allows the pump to completely empty the fluid present inside the chambers.

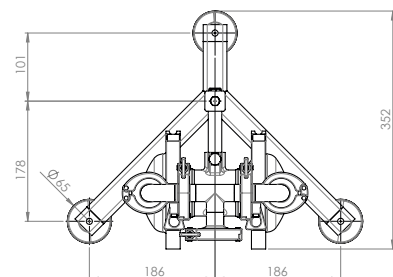
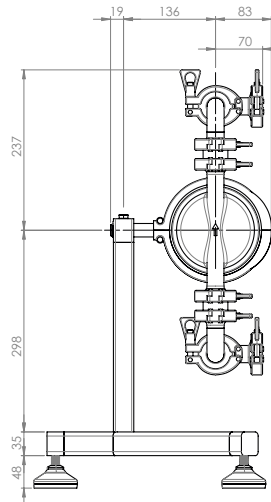
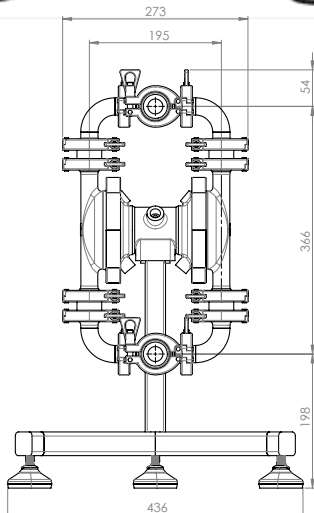

AISI 316 L

AISIBOXER-01



Maximum Dimensions

Height	618 mm
Width	436 mm
Depth	352 mm



Construction materials (casing and manifolds) and net weight

AISI 316 L*	16 Kg
	Temp. 3°C min.
	95°C max

*Mechanically polished - surface finish <0.8 µm